



**MSJ series**  
**MSJ 800**

**2V 870Ah**



**Valve Regulated Lead Acid Battery**

Maintenance-Free Sealed Lead Acid Battery.  
Absorbent Glass Mat (AGM) technology for efficient gas recombination of up to 99%.

**Design for Standby Power Applications**

<p><b>【Design Life】</b> Up to 20 Years in Standby Service at 25°C Eurobat (20°C) : 12 years and longer, Long Life</p> <p><b>【Operating Temperature Range】</b> Nominal Operating Temperature : 25°C (77°F) Discharge : -20°C ~ 50°C (-4°F~122°F) Charge: 0°C ~ 40°C (32°F~104°F) Storage: -20°C ~ 40°C (-4°F~104°F)</p>	<p><b>【Float Charging Voltage】</b> 2.21 ~ 2.25 VDC/Unit at 25°C (77°F)</p> <p><b>【Equalization Charging Voltage】</b> 2.35 VDC/Unit at 25°C (77°F)</p> <p><b>【Self Discharge】</b> Less than 10% after 90 days, can be stored up to 6 months at 25°C (77°F); Fully recharging is required before usage, and charged sooner if stored at higher temperature than 25°C (77°F).</p>
--	--

**Specification**

Nominal Voltage	2V (single cell per unit)	
Nominal Capacity	870 Ah @10hr-rate to 1.80V per cell @25°C (77°F)	
Weight	Approx. 56.70 Kg (124.97 lbs)	
Maximum Discharge Current	4800 A (5sec)	
Internal Resistance	Approx. 0.25 mΩ	
Short Circuit Current	--	
Maximum Charge Current	240 A	
Terminal type	I4 thread copper alloy terminal to accept M8 bolt	
Terminal breaking Torque	414 Kgf-cm / 359 Lbf-in / 40.57 N-m	
Container Material	Flame Retardant ABS (UL 94-V0)	
Dimensions	Depth (D)	373.0±2.5 mm      14.69±0.10 inch
	Width (W)	174.0±2.0 mm      6.85±0.08 inch
	Container height (h)	331.0±2.5 mm      13.03±0.10 inch
	Overall Height (H)	339.0±2.5 mm      13.15±0.10 inch

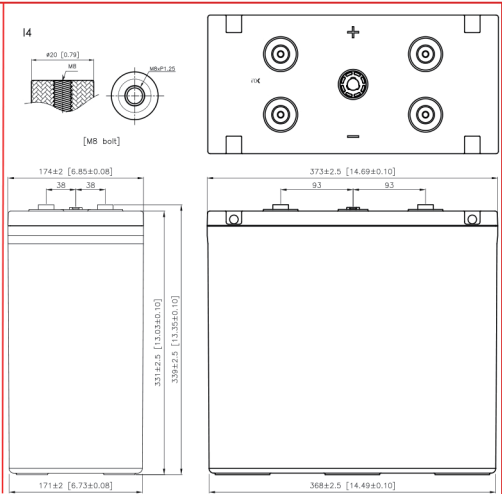

**Constant Current Discharge Characteristics Unit: A (25°C, 77°F)**

F.V/Time	15MIN	30MIN	60MIN	2HR	3HR	4HR	5HR	6HR	8HR	10HR	20HR	24HR
1.60V	1422	1078	625	357	256	197	161	136	108	91.3	45.6	38.0
1.67V	1274	1024	609	353	253	195	159	135	108	90.6	45.3	37.8
1.70V	1198	990	597	350	251	194	158	134	107	90.3	45.2	37.6
1.75V	1077	901	568	342	247	190	156	132	106	89.1	44.5	37.1
1.80V	922	798	524	327	238	184	151	129	103	87.0	43.5	36.3
1.83V	814	732	491	313	229	177	146	125	101	85.0	42.5	35.4

**Constant Power Discharge Characteristics Unit: W (25°C, 77°F)**

F.V/Time	15MIN	30MIN	60MIN	2HR	3HR	4HR	5HR	6HR	8HR	10HR	20HR	24HR
1.60V	2366	1857	1137	682	488	384	319	273	213	170	85.0	70.8
1.67V	2199	1786	1115	675	484	382	317	271	212	169	84.4	70.4
1.70V	2112	1740	1098	671	481	380	316	270	211	168	84.1	70.1
1.75V	1930	1626	1054	657	473	375	312	267	208	166	83.0	69.1
1.80V	1731	1468	983	631	458	365	304	261	202	162	80.8	67.3
1.83V	1560	1369	927	606	443	355	296	255	197	157	78.7	65.6

**Guang dong Xi shibi Power Co., Ltd.**

**Tel: +86 20 34628335**

**Fax: 626-453-0409**

**E-mail: csbusa@battery.com**

<http://www.battery-csb.com>